

MS7 - 400 SERIES STARTER MOTOR

IMPERIAL THREAD TERMINALS

TYPE / PART NO:	C.E. HOUSING HOUSING ASSY [4]	NOSE HOUSING ASSY [6]	BRUSH HOLDER ASSY [5]	CIRCLIP [21]
MS7-400	6512-175	851345/2	6512-179	6512-143
MS7-401	6512-175	851319/2	6512-179	6512-143
MS7-402	6512-175	851346/2	6512-179	6512-143
MS7-403	6512-77	851345/2	6512-178	-
MS7-404	6512-77	851346/2	6512-178	-
MS7-405	6512-175	851345/2	6512-179	6512-143
MS7-406	6512-175	851346/2	6512-179	6512-143
MS7-407	6512-175	851345/2	6512-179	6512-143
MS7-408	6512-175	851345/2	6512-179	6512-143

COMMON PARTS							
REF: NO:	PART NO:	QTY	DESCRIPTION	REF: NO:	PART NO:	QTY	DESCRIPTION
1	859799	1	FIELD RING ASSY - NOTE 2	41	5330-547	1	HEX NUT
2	856627	1	ARMATURE ASSY	42	859711	1	BRUSH PLATE & HOLDER ASSY
3	859689	1	SHIFT HSG ASSY - NOTE 6	43	859782	4	BRUSH
7	6512-92	1	SWITCH ASSY	44	6512-177	1	JUMPER & BOLT ASSY
8	852959	1	DRIVE UNIT	45	850161	2	BRUSH RETAINING SCREW
9	858432-4	1	LEAD ASSY	46	859778	4	BRUSH SPRING
10	850797	1	THRUST WASHER	47	6512-88	1	THERMAL TRIP ASSY
11	859507	1	SPRING CLEANER	48	6512-78	1	C.E.HSG. SUB - ASSY [NOTE 5]
12	850141	2	OILITE BUSH	49	850154	1	FELT WICK
13	858294	1	THRUST WASHER	50	858585	1	PLUG
14	5335-991	5	BUTTON HD SCREW	51	859788	1	" O " RING
15	854386	1	SHAKEPROOF WASHER	52	855174	1	SHIFT HOUSING BUSH
16	853239	2	CAM	53	859922	1	LEVER ARM
17	850148	2	THRUST WASHER - FIBRE	55	850144	1	" O " RING
18	5330-549	1	FLANGE NUT	56	850143	1	" O " RING
19	850466	6	SKT HD CAPSCREW	57	859714	1	FIELD RING
20	850150	6	SEALING PLUG	58	856852	4	POLE PIECE
23	850147	1	THRUST WASHER - FIBRE	59	859702	1	FIELD COIL & JUMPER ASSY
24	850146	1	THRUST WASHER	60	850184	8	SCREW
25	859777	1	JUMPER	61	859502	8	SEALING WASHER
26	5330-548	1	FLANGE NUT	62	850179	1	INSULATOR
27	850153	3	1/2" UNC HEX NUT	63	859802	1	TERMINAL BOLT
28	850475	2	SPRING WASHER	64	859781	1	INSULATION BUSH
29	859789	1	INSULATOR	65	850224	1	PLAIN WASHER
30	858418	1	" O " RING	66	859791	1	M12 HEX LOCKNUT
31	859822	1	BRUSH HOLDER INSULATOR	67	850182	2	INSULATION BUSH
32	6512-94	2	10/32 UNF HEX NUT	68	858418	1	" O " RING
33	5936-504	2	WASHER	69	859945	2	SPRING TENSION PIN
34	859790	1	INSULATION WASHER	70	850180	1	INSULATOR
35	850224	2	PLAIN WASHER	71	860088	1	INSULATOR
36	850651	1	SHAKEPROOF WASHER	72	859688	1	SHIFT HOUSING
37	859783	4	SEALING WASHER	73	859960	1	PIVOT PIN
38	859240	4	THROUGH BOLT	74	850137	1	OIL SEAL
39	5335-992	2	BUTTON HD SCREW				
40	854101	2	PLAIN WASHER				

NOTE 1 - NOSE HOUSING ASSY [ITEM 6] IS FITTED WITH BUSH, PART NO: 850141 [ITEM 12]

NOTE 2 - FIELD RING ASSY [ITEM 1] COMPRISES ITEMS 57, 58, 59, 60, 61, 62, 63, 64, 65, 66, 67, 68, 69, 70 & 71

NOTE 3 - BRUSH HOLDER ASSY [ITEM 5] COMPRISES ITEMS 42, 43, 44, 45 & 46

NOTE 4 - C.E. HOUSING ASSY [ITEM 4] COMPRISES ITEMS 48, 49, 50 & 51

NOTE 5 - C.E. HOUSING SUB - ASSY [ITEM 48] IF FITTED WITH BUSH ITEM 12

NOTE 6 - SHIFT HOUSING ASSY [ITEM 3] COMPRISES ITEMS 15, 41, 52, 53, 55, 56, 72, 73 & 74

MS7 - 400 SERIES STARTER MOTOR

SEE NOTE 6
NOT SHOWN

SEE NOTE 1

SEE NOTE 6

SEE NOTE 2
AND SHEET 2

SEE NOTE 3

SEE NOTE 5

SEE NOTE 4
NOT SHOWN

SHEET 1 OF 2

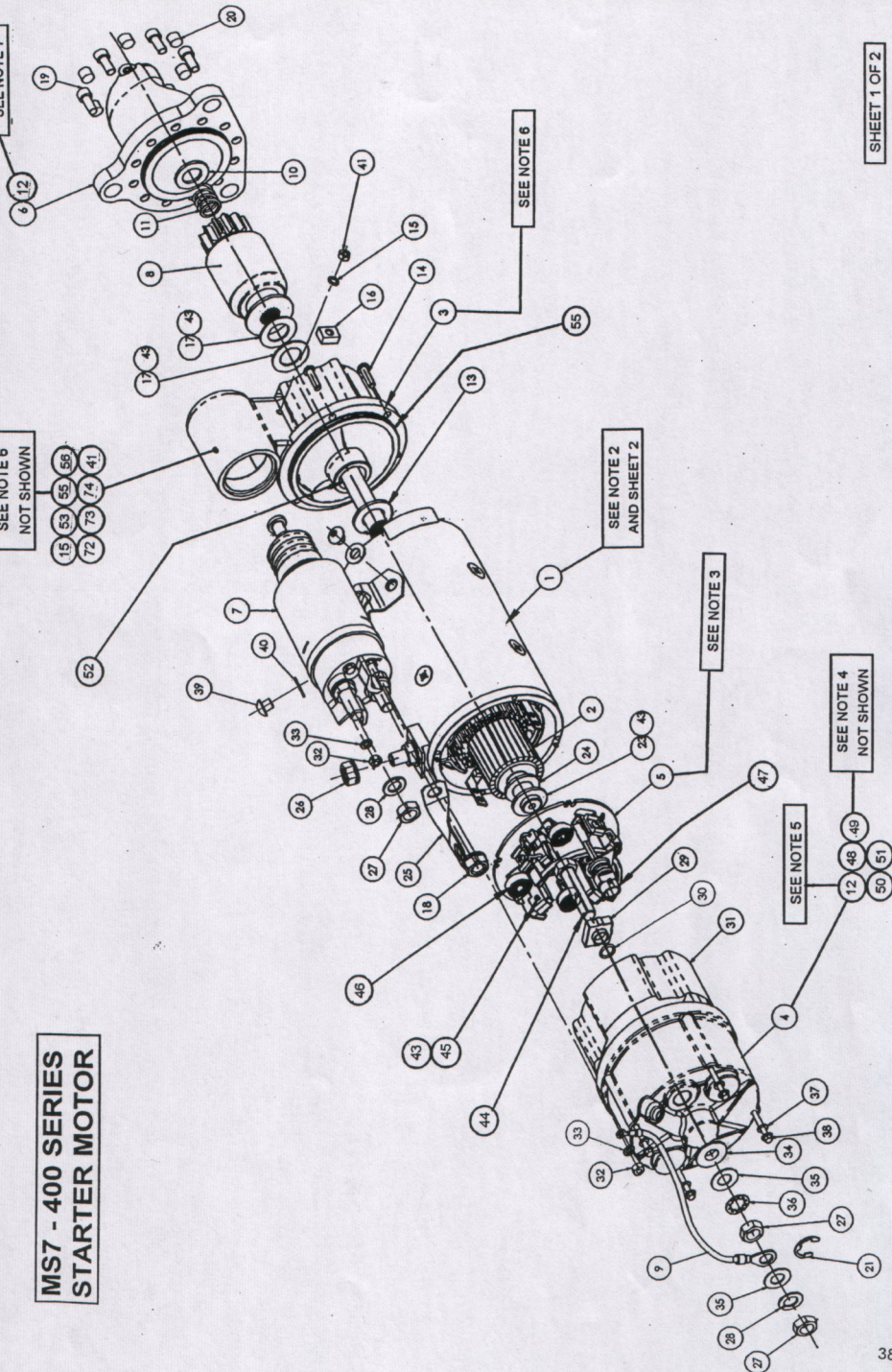

MS7 - 400 SERIES STARTER MOTOR

